

## RF1™

### FITTING GUIDE

FD60



#### LORIENT SODIUM SILICATE LINER

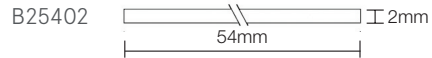

#### CONTENTS

- RF1™ glazing system
- Sodium silicate intumescent liner (B25402)

#### NO TOOLS REQUIRED

#### STEP 1

Ensure the aperture is square cornered and true.

#### STEP 2

Apply the sodium silicate liner to the aperture, effectively reducing the size by 2mm all round.

#### STEP 3

Ensure the surface is free from dust and grease. Gradually remove the protective backing paper from the RF1™, and apply the glazing seal to the glazing bead. Press the exposed self-adhesive face of the seal onto the glazing edge of the bead - ensuring adequate pressure is applied to activate adhesive backing properties. The top "cap" of the seal should overlap the top edge of the bead.

#### NOTE

We do not recommend oil or solvent based paint/primers.

**The bead should be hardwood (excluding Ash and Beech) and minimum density 610 kg/m<sup>3</sup>.**

#### STEP 4

Mitre beads to the correct lengths for the size of the aperture, ensuring the cut lengths form a neat "push fit" finish.

#### NOTE

If preferred, the bead can be mitred first, and then the RF1™ glazing seal applied to the bead as described in stage 1. If doing so, ensure the RF1™ is trimmed neatly to the end of the mitred corner.

#### STEP 5

Push the first set of bead lengths into position around the full periphery of the opening.

#### STEP 6

Securely pin or screw into place, using 50mm long steel pins at 150mm nom. centres, or steel screws 50mm long (No. 8) at 150mm nom. centres.

#### STEP 7

Working from the reverse side, press the aperture glass into position against the fixed bead.

#### STEP 8

Ensuring that the located glass is secure, particularly if working vertically, repeat stages 1 to 6 above. If correctly located, the glass should now be pinched between opposing beads and seal faces.

#### STEP 8

Pin or screw the opposing bead into position.

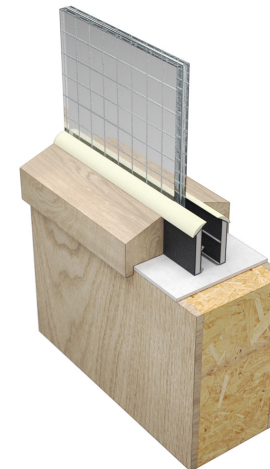
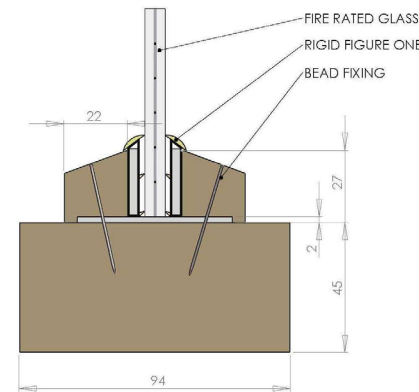

#### NOTE

The bead dimension must be appropriate for the glass type and door core being used, and must relate to test evidence.

RF1™ can be used in a screen application as well as for doors. Please glaze as instructed above and reduce the depth of rebate in the bottom of the beading to fit neatly over the 2mm thick sodium silicate liner. If further information is required please contact our Technical Services Team.

The expansion allowance should be as per the glass manufacturers certificates. As a general rule there should be a minimum gap of 4mm to each glass edge. Hardwood or non-combustible setting blocks may be used along the bottom edge only in order to facilitate this.

V1



Lorient Polyproducts Ltd  
Endeavour House  
Fairfax Road  
Heathfield Ind Estate  
Newton Abbot  
Devon TQ12 6UD  
United Kingdom

+44 (0)1626 834252  
[www.lorientgroup.com](http://www.lorientgroup.com)

All rights reserved. No part of this fitting guide may be reproduced, stored in a retrieval system, or transmitted in any means, electronic, mechanical, photocopying, recording or otherwise without the written permission of Lorient Polyproducts Limited.  
© Lorient Polyproducts Ltd 2018