

WALL 12

LVV40 FITTED INTO RIGID WALL CONSTRUCTION

DESCRIPTION	
1	Rigid wall construction
2	Mortar facing over irregular surface
3	Pressed steel or aluminium cover grille
4	LVV40 air transfer grille
5	Air transfer grille fixing screws into wall plugs
6	Use Lorient intumescent sealant to bed air transfer grille into the wall
7	Cover grille fixing screws into wall plugs.
<p>In order to comply with CF564, the upper edge of the grille shall be no higher than 3000mm from floor level. The lower edge of the grille shall be no closer than 400mm to floor level.</p>	

CONTENTS

- LVV40 air transfer grille
- Cover grille (optional)

TOOLS REQUIRED

- 50mm screws
- Wall plugs for 50mm screws
- Lorient intumescent sealant

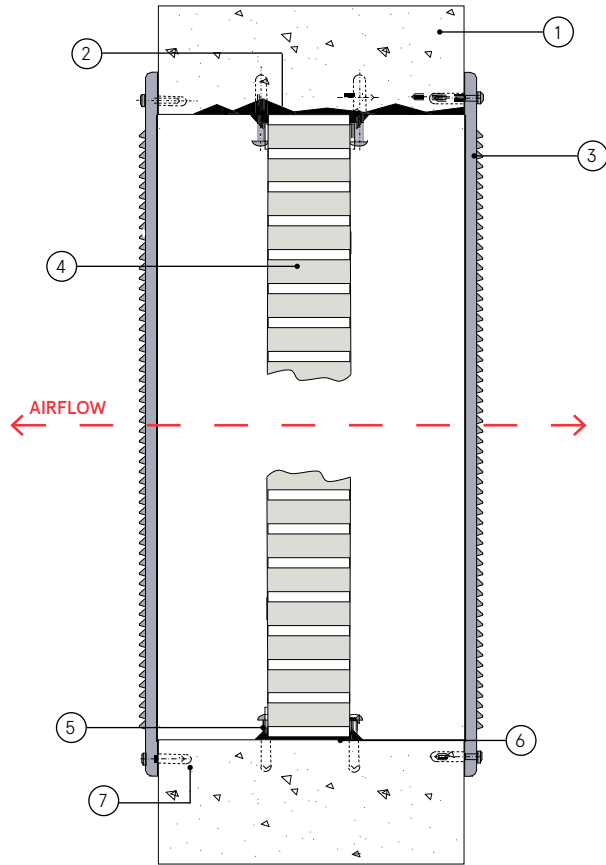

LVV40 into a rigid wall

FR60

Fire Resistance in accordance with

BS 476-22:1987

Approval Ref

WF185829/A
Certifire CF564

Max single cell size

600mm x 600mm

LVV40 air transfer grilles are supplied 2mm less than the nominal size e.g. a 300mm x 300mm is actually 298mm x 298mm.

INSTALLATION INSTRUCTIONS

- ▶ Cut the aperture to the required size with a maximum gap all around of 5mm. If resulting aperture is out of square, irregular or oversized, make good with mortar.
- ▶ Trial fit the LVV40 into the aperture and ensure that it can be positioned within the section of the wall but not necessarily in the mid position, without jamming or twisting.
- ▶ Mark the position of drill points into wall either side of the LVV40.
- ▶ Remove the LVV40 from the wall aperture.
- ▶ Fix screws through side wall of LVV40 with a minimum of 4 screws. For larger units use a maximum of 200mm between centres.
- ▶ Position LVV40 and repeat installation of screws on closest side of the LVV40.
- ▶ Bed in sealant around LVV40. Clean off surplus and ensure outer edge of the air transfer grille is fully sealed.
- ▶ Position cover grille centrally over one face of the LVV40 and fix using wall plugs supplied.
- ▶ Repeat to other face if two cover grilles are to be fitted.
- ▶ **Note: Fixings supplied by others.**