



FIRE DOOR 14

LVH44 AIR TRANSFER GRILLE FITTED INTO STEEL FRAME WITH ANGLE FIXINGS

DOOR MOUNTED SYSTEMS

DESCRIPTION

- 1 Steel frame as part of associated doorset framing system
 - 2 Lorient intumescent sealant around LVH44 perimeter to a maximum clearance of 10mm
 - 3 Lorient LVH44 intumescent air transfer grille
 - 4 4mm intumescent liner
 - 5 **Fixing angle:** 20 x 20 x 1mm thick minimum galvanised steel angles fixed to air transfer grille unit with self tapping screws and to steel frame with self tapping screws
- Fixing option 1:** 20mm wide angle tabs, central to all four sides or at 200mm maximum centres
- Fixing option 2:** Full width angles top and bottom only with 200mm fixing centres

CONTENTS

- LVH44 air transfer grille
- 4mm graphite liner
- Cover grille (optional)

TOOLS REQUIRED

- Angle fixings
- Self tapping screws (3.5 x 16mm)
- Lorient intumescent sealant

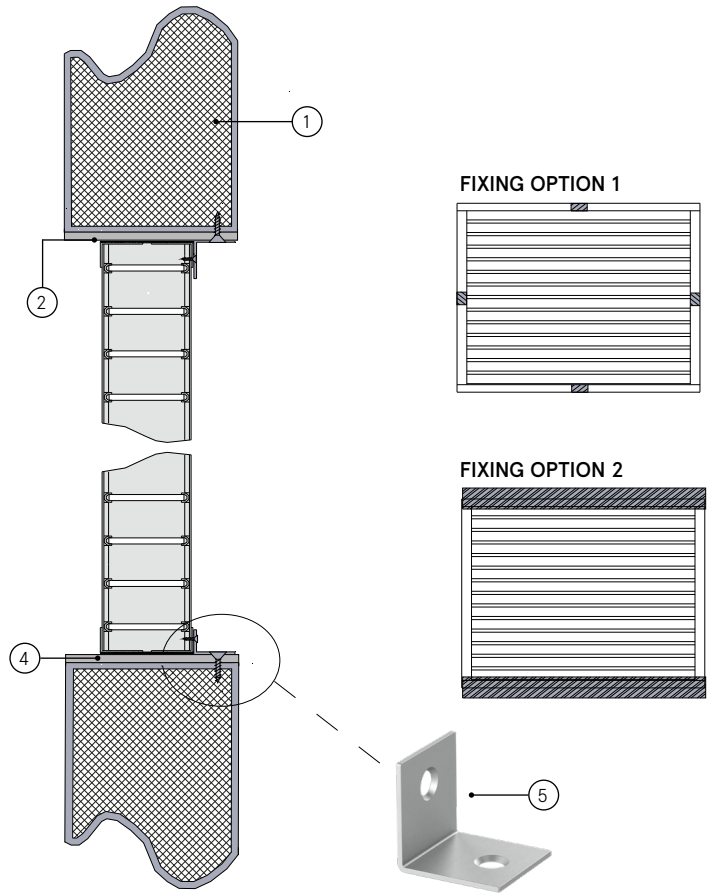

LVH44 for steel frame with angle fixings

FD120

Fire Resistance in accordance with

BS 476-22:1987

Approval Ref

WFRC C121316 (AW4S1)

Max single cell size

Any rectangular shape up to 1200 x 600mm

LVH44 air transfer grilles are supplied 2mm less than the nominal size e.g. a 300mm x 300mm is actually 298mm x 298mm.

INSTALLATION INSTRUCTIONS

- ▶ Apply Lorient intumescent liner to the inside faces of the aperture.
- ▶ Fix the mounting angles onto the LVH44 air transfer grille using self tapping screws to **one side only**.
- ▶ Insert LVH44 into steel frame. (Note: air transfer grille does not have to be centrally positioned in the opening).
- ▶ Fix the angles to the steel frame with self tapping screws.
- ▶ Apply a bead of Lorient intumescent sealant around the perimeter of LVH44 as shown (note: maximum clearance of 10mm applies).
- ▶ **Note: Fixings supplied by others.**